

# ***NON-Technical Manual for using the FHP Portable Radio***

## **I. Introduction**

Our FHP Portable radio is a M/A Com P7170IP 800MHz radio. It is part of the SLERS (Statewide Law Enforcement Radio System). It operates in the 800 MHz frequency range (like old cells phones used too), and is digitally encrypted (even if you could scan it, you would only hear computer data).

## **II. Battery**

- The P7100 series portable radios use rechargeable, recyclable Nickel Cadmium (NiCd) or Nickel Metal Hydride (NiMH) batteries.
- Periodically condition NiCD batteries to avoid the memory effect (run them all the way down, and then fully charge them). If a NiCD battery is repeatedly charged and not fully discharged, the result is lower voltage and lower capacity. Fortunately, both voltage and capacity are restored through battery conditioning.

### **Removing the Battery Pack**

*Make sure the power to the radio is turned OFF.*

1. Press the latch at the bottom of the battery pack.
2. Lift the battery pack from the bottom.
3. Remove the battery pack from the radio.

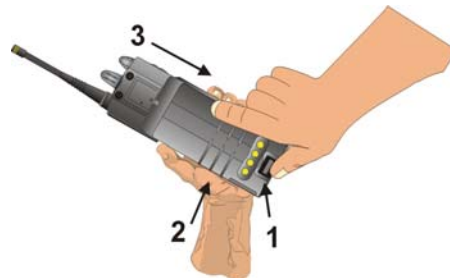

### **Attaching the Battery Pack**

*Make sure the power to the radio is turned OFF.*

1. Align the tab on the top of the battery pack with the slot at the top of the battery cavity.
2. Push the battery pack down to attach the battery to the radio.
3. Verify that the battery pack is properly latched to the radio.



## **III. Controls**

### **Top Controls**

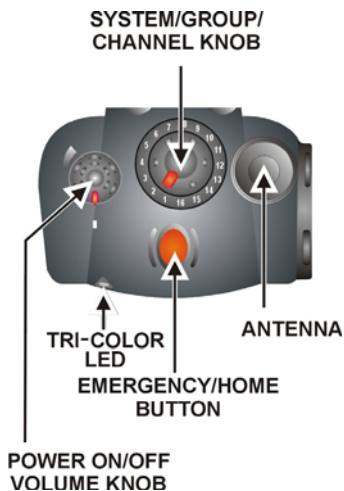

### **Side Controls**

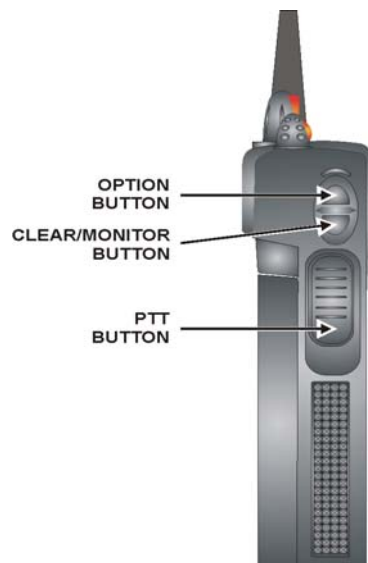

### **Front Controls**



**Power On-Off / Volume** - Applies power to and adjusts the receiver's volume.

- ✦ Rotating the control clockwise applies power to the radio. A single alert tone (if enabled through programming) indicates the radio is operational.
- ✦ Rotating the control clockwise increases the volume level. While adjusting the volume the display will momentarily indicate the volume level (i.e. VOL=27). The volume range is from a minimum programmed level of zero (displayed as OFF in the display) up to 31, which is the loudest level.

**Control Knob** - Selects systems or group/channels (depending on programming). This is a 16-position rotary knob. *See the list on page 3 for Troop F TalkGroups.*

**PTT Button** - Push-To-Talk must be pressed before voice transmission begins. The radio's ID is transmitted upon depression of the PTT button. *Be sure to wait for the beeps to stop before you start talking.*

**Emergency Button** – Is used to declare an emergency by pressing and holding for a programmed duration. The button is replicated on the Lapel Microphone.

- ✦ For our radios, if you press and hold for 1.5 seconds, it will open the mic, and you have about 10 seconds to get your message out. You DO NOT need to hold the button or press the PTT (Push-to-talk button).
- ✦ If you need to activate this, press and hold for 1.5 seconds and the radio will beep, give your location and what you need - "I-75 mile marker 107, 10-24". Dispatch will be able to hear *everything* that you say for about 10 seconds.
- ✦ If you accidentally activate this button, contact dispatch immediately. Give your radio ID and advise them of an "Accidental Activation". They may ask for additional information to verify that you are okay... maybe your Permanent ID Number (another good reason to remember it).

#### IV. Display

*The first line shows the Troop System and Tower Site.*

Generally, in Troop F, it will show one of these tower sites:

<b>F-FTMYRS</b>	<b>F-BONITA</b>	<b>F-PIN ISL</b>	<b>F-NAPLES</b>	<b>F-EAST</b>
<b>F-LABELL</b>	<b>F-ENGLWD</b>	<b>F-CARNES</b>	<b>F-I75 E</b>	<b>F-IMKOLE</b>
<b>F-MARCO</b>	<b>F-FRUTVL</b>	<b>F-HARDEE</b>	<b>F-HGHLND</b>	<b>F-DESOTO</b>
<b>F-GLADES</b>	<b>F-TAMPA</b>	<b>F-VENICE</b>	<b>F-PNCRST</b>	<b>F-MORHAV</b>

Some of these sites overlap other Troops for use in border areas.

*The second line is the TalkGroup (channel) that you are on.* See the list on the next page.

Generally, it will be something like **PTL-FTM1**, **PTL-NAP1**, **PTL-EAST**.

You also have other "channels" that you might be requested to go to:

- ✦ **HF-CAR2CAR** is a Car to Car channel for any information that you don't want to put on the main channel. It CAN be heard by anyone else on that "channel".
- ✦ **HF-DET1** is a Detail "channel" and would be used at events like the Miromar Fireworks detail.

Other symbols may appear in the third line:

A rotating ► indicates that you are in Scan Mode.

The battery power is indicated like this →

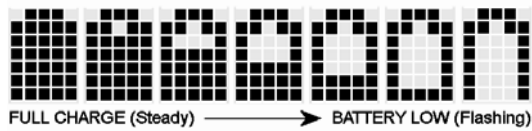

## V. Basic Operation

### TURNING ON THE RADIO

1. Power ON the radio by rotating the POWER ON-OFF/VOLUME knob clockwise. A short alert signal indicates the radio is ready to use.
2. The display shows the last selected system and group or a default system and group (depending on programming).
3. Adjust the POWER ON-OFF/VOLUME knob to the desired volume level.
4. Select the desired system and group. The display indicates the current system and group names.
5. The radio is now ready to transmit and receive calls.

### TALKGROUP (“Channel”) SELECTION

From the control knob, select a TalkGroup by turning the knob to the desired number position (1-16). The display registers the system name on line one and the Talkgroup on line two. For Troop F, the Talkgroups are listed on the table below:

1	PTL-SAR1	Sarasota 1		9	HF-P-TAC	Tactical
2	PTL-SAR2	Sarasota 2		10	HF-DET1	Detail 1
3	PTL-BRA1	Bradenton 1		11	HF-DET2	Detail 2
4	PTL-NAP1	Naples 1		12	n/a	<i>show up as HF-DET2 by default</i>
5	PTL-EAST	East Dist.		13	n/a	
6	PTL-FTM1	Fort Myers 1		14	n/a	
7	PTL-FTM2	Fort Myers 2		15	IA-FTM-1	Comm. Diagnostics 1
8	HF-CAR2CAR	Car to Car		16	IA-FTM-2	Comm. Diagnostics 2

### LOCKING/UNLOCKING KEYPAD

1. Press (M) button.
2. Within 1 second, press the Option button on the side of the radio.

## VI. Troubleshooting

### CC SCAN

CC SCAN will be displayed if communication with the system's control channel cannot be established. This may occur if, for example, the radio is out of range of the trunking site. It may be necessary to move to another location or select another trunking system to re-establish the control channel link for trunked mode operations. CC SCAN is displayed on the group line until a control channel is accessed.

### **Unable to Hear Radio Traffic on home TalkGroup when in other areas.**

The tower sites have a limited number of voice channels. If you are on a TalkGroup that is within the Troop, but not local to the tower that you are operating off of, you may lose the ability to receive transmissions on that talkgroup. Without going into a technical discussion, the system balances resources (channels) for local operations. If you are “roaming” (for lack of a better word) in Naples, and still on PTL-FTM1, the tower will not use resources to connect you to Fort Myers unless you are transmitting. If you are in the Naples area, you should be on PTL-NAP1 anyway.

### **VII. Dos & Don'ts**

- ✎ Do not have your portable on one talkgroup and your mobile on another – it taxes the tower resources.
- ✎ Do not have your portable volume up while in the car – you will get a very bad echo.
- ✎ Do not forget to turn your portable ON when you leave the car – you will be embarrassed when 20 LEOs show up at the rest area because you didn't hear the dispatcher call you for 10-13.
- ✎ Do make sure you are transmitting on the proper talkgroup, and that you are on the right tower for your area.
- ✎ Do take care not to drop the radio or microphone – they are delicate and expensive
- ✎ Do check the battery level before you leave for patrol, and do make sure to put the radio back in the charger.
- ✎ Do make sure to sign the radio out and in on the log sheet.
- ✎ Do use the portable to go 10-8 once you have it. This will associate that radio (which is listed as a spare) to your ID# in the CAD.
- ✎ Do speak clearly into the microphone. It should be 2-4 inches away from your mouth, and you should use a normal voice when speaking.
- ✎ Do learn and use the proper codes, signals, and ID numbers. However, for example, if in an emergency you forget the code for an ambulance just use plain talk to get what you need.

***The point of communications is to send a clear message. If you cannot be understood, you're defeating the purpose of having the radio AND possibly delaying a vital response.***